

## Blum TANDEM Concealed Runner

The TANDEM runner is the premier solution for wooden drawers and pullouts from Blum. Featuring ultra light running action, on nylon cylindrical rollers, for maintenance free lasting use, the TANDEM runner now has integrated BLUMOTION for silent and effortless closing action. The concealed fitting ensures that timber features are accented, enabling you to manufacture furniture that meets the very highest expectations, combining function with aesthetic appeal.

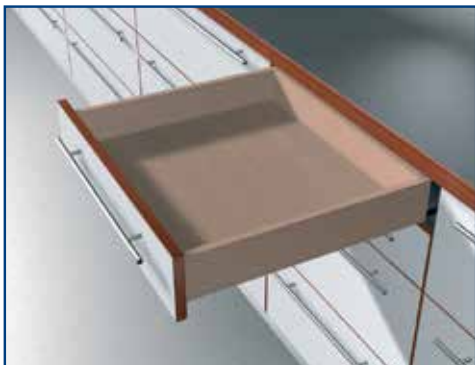

## Blum TANDEM Range with Locking Device



- Full Extension
- 30 kg weight capacity
- Option for max 16 mm drawer sides and 19 mm drawer sides
- Connection via locking device
- Integrated BLUMOTION soft Close

**BLUMOTION**  
inside



- 7/8 Extension
- 25 kg weight capacity
- Option for max 16 mm drawer sides and 19 mm drawer sides
- Connection via locking device
- Integrated BLUMOTION soft Close

**BLUMOTION**  
inside



- Single Extension
- 30 kg weight capacity
- Option for max 16 mm drawer sides and 19 mm drawer sides
- Connection via locking device
- Integrated BLUMOTION soft Close

**BLUMOTION**  
inside



- 7/8 Extension
- 25 kg weight capacity
- Option for max 16 mm drawer sides and 19 mm drawer sides
- Connection via locking device
- Integrated TIP-ON mechanical opening system

**TIP-ON**  
inside



- Single Extension
- 30 kg weight capacity
- Option for max 16 mm drawer sides and 19 mm drawer sides
- Connection via locking device
- Integrated BLUMOTION soft Close

**TIP-ON**  
inside

## Blum TANDEM Range with Peg Fix

- Full Extension
- 30 or 50 kg weight capacity options
- Option for max 16 mm drawer sides and 19 mm drawer sides
- Connection via Peg Fix
- Integrated BLUMOTION soft Close

### BLUMOTION inside

- 7/8 Extension
- 25 kg weight capacity
- Option for max 16 mm drawer sides and 19 mm drawer sides
- Connection via Peg Fix
- Integrated BLUMOTION soft Close

### BLUMOTION inside

- Single Extension
- 30 kg weight capacity
- Option for max 16 mm drawer sides and 19 mm drawer sides
- Connection via Peg Fix
- Integrated BLUMOTION soft Close

### BLUMOTION inside

- 7/8 Extension
- 25 kg weight capacity
- Option for max 16 mm drawer sides and 19 mm drawer sides
- Connection via Peg Fix
- Integrated TIP-ON mechanical opening system

### TIP-ON inside

- Single Extension
- 30 kg weight capacity
- Option for max 16 mm drawer sides and 19 mm drawer sides
- Connection via Peg Fix
- Integrated BLUMOTION soft Close

### TIP-ON inside

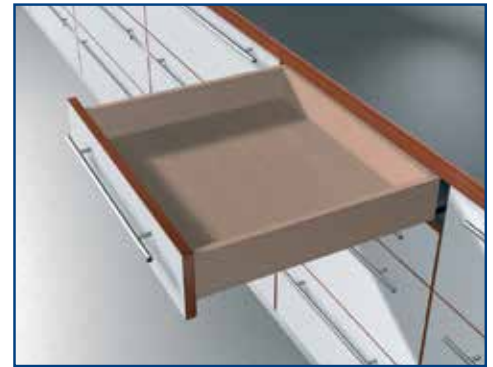

## Blum TANDEM BLUMOTION Full Extension - Locking Device

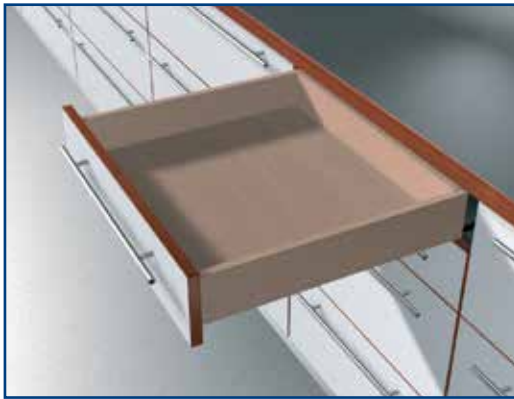

- Drawer panel widths up to 16 mm with TANDEM-16 and up to 19 mm can be used with TANDEM-19
- Concealed TANDEM Full extension
- Integrated BLUMOTION for silent and effortless closing
- Carriage system with high impact cylindrical rollers
- 30kg dynamic load capacity up to runner length 600 mm
- Tool free height adjustment
- Tool free front tilt adjustment
- Built in width and depth tolerance compensation

### BLUMOTION

inside

#### Space Requirement

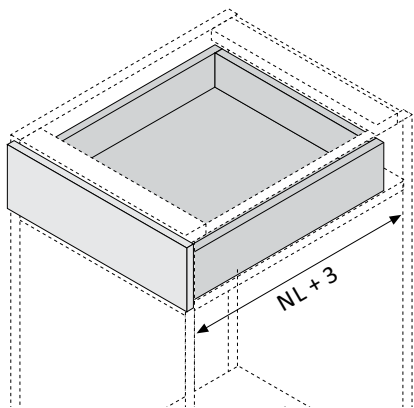

#### Components

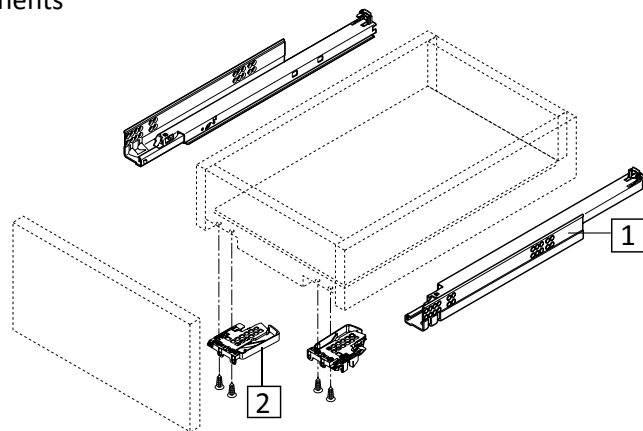

1. Runners
2. Locking Device

#### Height Requirement

Z = 21.0 mm TANDEM-16  
 Z = 24.5 mm TANDEM-19  
 \* +3mm side stabilisation

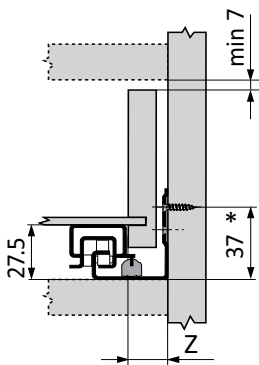

IDW = Internal drawer width

ICW = Inner cabinet width

X = 42 mm TANDEM-16

X = 49 mm TANDEM-19

Y = 16 mm TANDEM-16

Y = 19 mm TANDEM-19

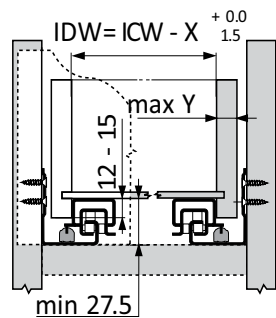

DL = Drawer Length

NL = Nominal Length

\* + an extra 12 mm if side stabiliser is used

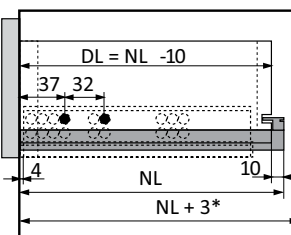

IDL = Inner Drawer Length

DL = Drawer Length

NL = Nominal Length

X = Drawer Front

\* + an extra 12 mm if side stabiliser is used

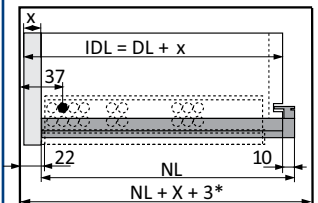

Note: For runner positions and further technical information see Page 1.111 - 1.113

## Blum TANDEM BLUMOTION Full Extension - Locking Device

Drawer Assembly - Front

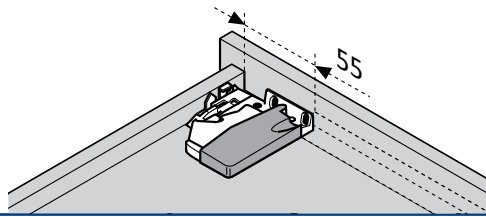

Drawer Assembly - Back

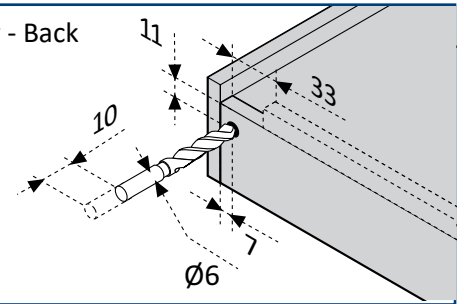

### TANDEM Full Extension

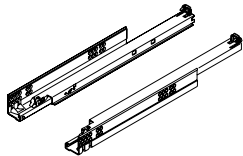

Nominal Length	TANDEM 30 kg	TANDEM-19 30 kg	P.U
270 mm	B560H270B	B560F270B	6
350 mm	B560H350B	B560F350B	6
400 mm	B560H400B	B560F400B	6
450 mm	B560H450B	B560F450B	6
500 mm	B560H500B	B560F500B	6
550 mm	B560H550B	B560F550B	6
600 mm	-		6
650 mm	-		6
700 mm	-		6
750 mm	-		6

### TANDEM Locking Device

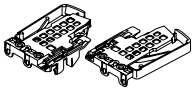

Fixing Method	Left Hand	Right Hand	P.U
Screw On	BT511700L	BT511700R	100

### TANDEM depth stop for Inner Drawers (Recommended)

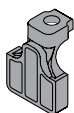

Art. No.	P.U
B2985500	10

### TANDEM Side Stabilisation Kit (Optional)



Drawer Length	Art. No.	P.U
≤ 750 mm	BZST750TV	10

For cabinet widths ≤ 1400mm for Cutting to size

### Back fixing bracket for MOVENTO / TANDEM (Optional)

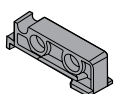

Art. No.	P.U
BT517000.01	10

For pull out shelves or where no hole is drilled in the back of drawer.  
Used Left and right, reduce the drawer side depth by an additional 10 mm

## Blum TANDEM BLUMOTION 7/8 Extension - Locking Device

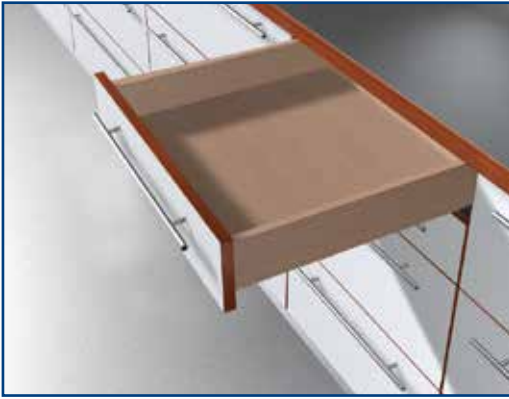

- Drawer panel widths up to 16 mm with TANDEM-16 and up to 19 mm can be used with TANDEM-19
- Concealed TANDEM 7/8 extension
- Integrated BLUMOTION for silent and effortless closing
- Carriage system with high impact cylindrical rollers
- 25kg dynamic load capacity up to runner length 500 mm
- Tool free height adjustment
- Built in width and depth tolerance compensation

### BLUMOTION

inside

#### Space Requirement

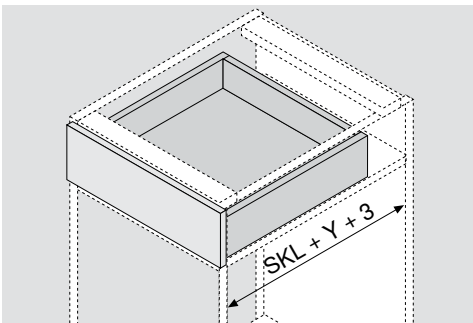

Drawer Depth (SKL) mm	Y
300 mm / 350 mm	25 mm
400 mm / 450 mm	35 mm
500 mm	30 mm

#### Components

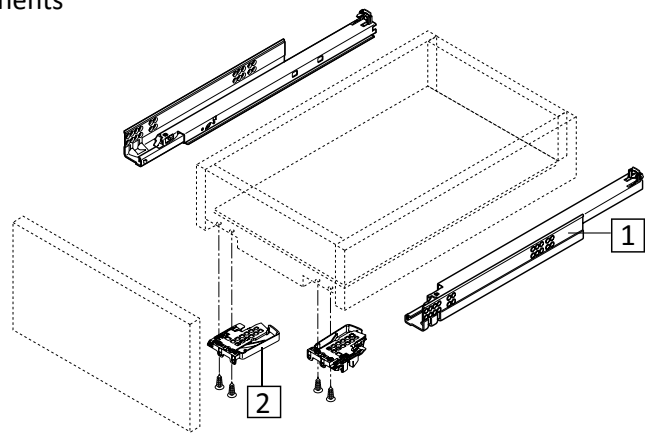

1. Runners
2. Locking Device

#### Height Requirement

Z = 21.0 mm TANDEM-16  
 Z = 24.5 mm TANDEM-19  
 A = 3mm to interchange with full extension

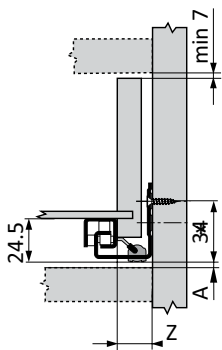

IDW = Internal drawer width  
 ICW = Inner cabinet width

X = 42 mm TANDEM-16  
 X = 49 mm TANDEM-19  
 Y = 16 mm TANDEM-16  
 Y = 19 mm TANDEM-19

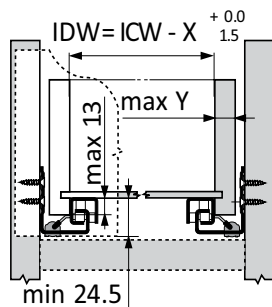

DL = Drawer Length  
 NL = Nominal Length  
 Y = Hook Position

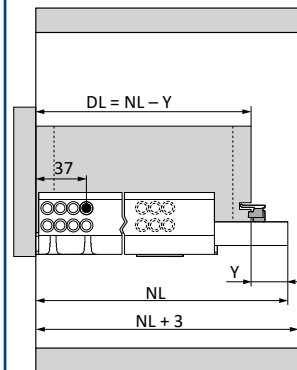

IDL = Inner Drawer Length  
 DL = Drawer Length  
 NL = Nominal Length  
 X = Drawer Front

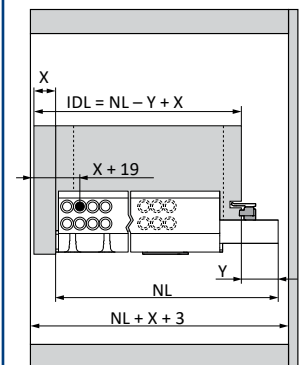

Note: For runner positions and further technical information see Page 1.111 - 1.113

## Blum TANDEM BLUMOTION 7/8 Extension - Locking Device

Drawer Assembly - Front

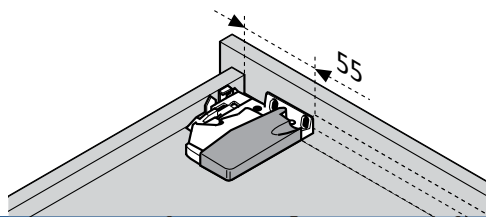

Drawer Assembly - Back

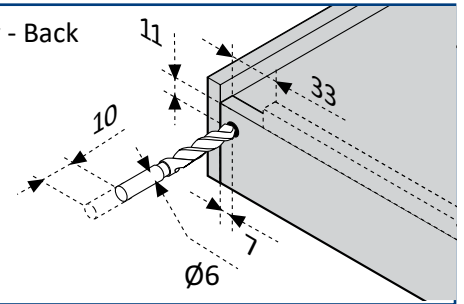

### TANDEM 7/8 Extension

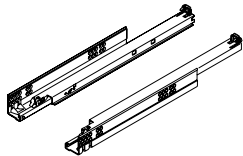

Drawer Depth	Nominal Length	TANDEM-16 25 kg	TANDEM-19 25 kg	P.U
300 mm	325 mm	B540H300B	B540F270B	6
350 mm	375 mm	B540H350B	B540F350B	6
400 mm	435 mm	B540H400B	B540F400B	6
450 mm	485 mm	B540H450B	B540F450B	6
500 mm	530 mm	B540H500B	B540F500B	6

### TANDEM Height Adjustable Locking Device

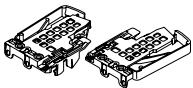

Fixing Method	Left Hand	Right Hand	P.U
Screw On	BT511700L	BT511700R	100

### TANDEM depth stop for Inner Drawers (Recommended)

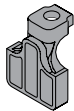

Art. No.	P.U
B2985500	10

### TANDEM Locking Device (Alternative)

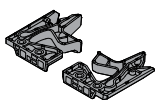

Fixing Method	Left Hand	Right Hand	P.U
Screw On	BT511400L	BT511400R	300

No height adjustment and cannot be used Depth Stop above

### Back fixing bracket for MOVENTO / TANDEM (Optional)

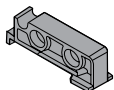

Art. No.	P.U
BT517000.01	10

For pull out shelves or where no hole is drilled in the back of drawer.  
Used Left and right, reduce the drawer side depth by an additional 10 mm

## Blum TANDEM BLUMOTION Single Extension - Locking Device



- Drawer panel widths up to 16 mm with TANDEM-16 and up to 19 mm can be used with TANDEM-19
- Concealed TANDEM runner
- Integrated BLUMOTION for silent and effortless closing
- Carriage system with high impact cylindrical rollers
- 30kg dynamic load capacity up to runner length 550 mm
- Tool free height adjustment
- Built in width and depth tolerance compensation

### BLUMOTION

inside

#### Space Requirement

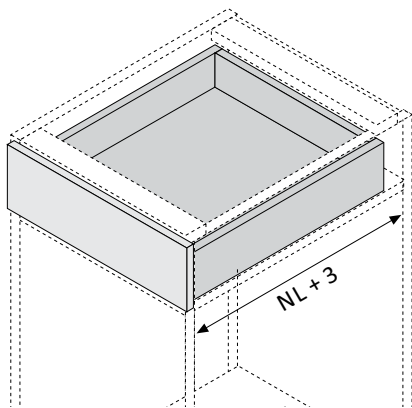

#### Components

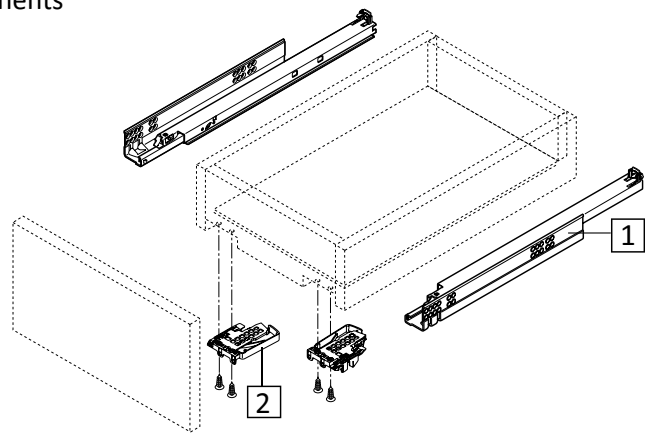

1. Runners
2. Locking Device

#### Height Requirement

\* +3mm side stabilisation

Z = 21.0 mm TANDEM-16

Z = 24.5 mm TANDEM-19

A = 3mm to interchange with full extension

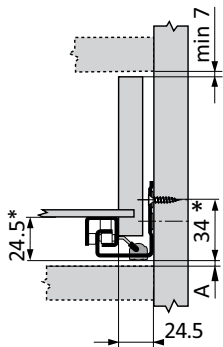

IDW = Internal drawer width

ICW = Inner cabinet width

X = 42 mm TANDEM-16

X = 49 mm TANDEM-19

Y = 16 mm TANDEM-16

Y = 19 mm TANDEM-19

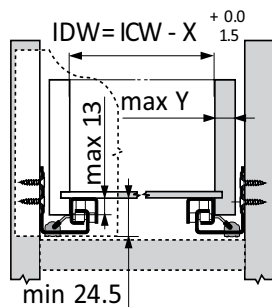

DL = Drawer Length

NL = Nominal Length

\* + an extra 12 mm if side stabiliser is used

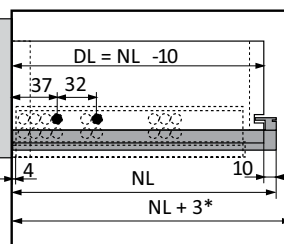

IDL = Inner Drawer Length

DL = Drawer Length

NL = Nominal Length

X = Drawer Front

\* + an extra 12 mm if side stabiliser is used

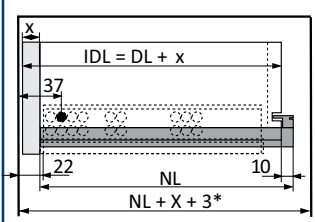

Note: For runner positions and further technical information see Page 1.111 - 1.113



## Blum TANDEM BLUMOTION Single Extension - Locking Device

Drawer Assembly - Front

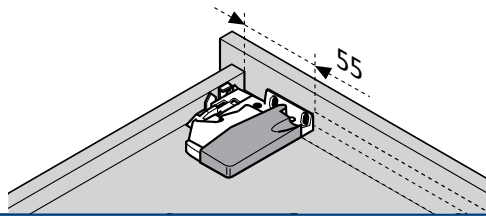

Drawer Assembly - Back

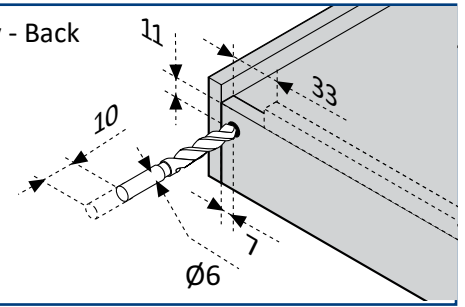

### TANDEM BLUMOTION Single Extension

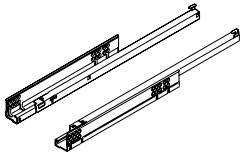

Nominal Length	TANDEM-16 30 kg	TANDEM-19 30 kg	P.U
270 mm	B550H270B	B550F270B	12
300 mm	B550H350B	B550F350B	12
400 mm	B550H400B	B550F400B	12
450 mm	B550H450B	B550F450B	12
500 mm	B550H500B	B550F500B	12
550 mm	B550H550B	B550F550B	12

### TANDEM Locking Device

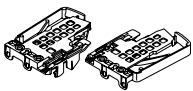

Fixing Method	Left Hand	Right Hand	P.U
Screw On	BT511700L	BT511700R	100

### TANDEM depth stop for Inner Drawers (Recommended)

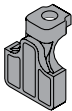

Art. No.	P.U
B2985500	10

### TANDEM Locking Device (Alternative)

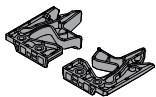

Fixing Method	Left Hand	Right Hand	P.U
Screw On	BT511400L	BT511400R	300

No height adjustment and cannot be used Depth Stop above

### TANDEM Side Stabilisation Kit (Optional)



Drawer Length	Art. No.	P.U
≤ 750 mm	BZST750TV	10

For cabinet widths ≤ 1400mm for Cutting to size

### Back fixing bracket for MOVENTO / TANDEM (Optional)

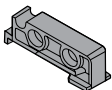

Art. No.	P.U
BT517000.01	10

For pull out shelves or where no hole is drilled in the back of drawer.  
Used Left and right, reduce the drawer side depth by an additional 10 mm

## Blum TANDEM TIP-ON 7/8 Extension - Locking Device



- Drawer panel widths up to 16 mm with TANDEM-16 and up to 19 mm can be used with TANDEM-19
- Concealed TANDEM 7/8 extension
- Integrated TIP-ON opening system for handleless fronts
- Carriage system with high impact cylindrical rollers
- 25kg dynamic load capacity up to runner length 500 mm
- Tool free height adjustment
- Built in width and depth tolerance compensation

**TIP-ON**

inside

### Space Requirement

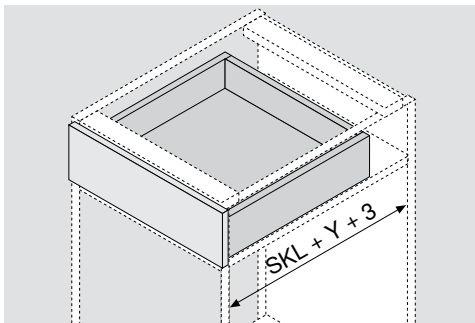

Drawer Depth (SKL) mm	Y
300 mm / 350 mm	25 mm
400 mm / 450 mm	35 mm
500 mm	30 mm

### Components

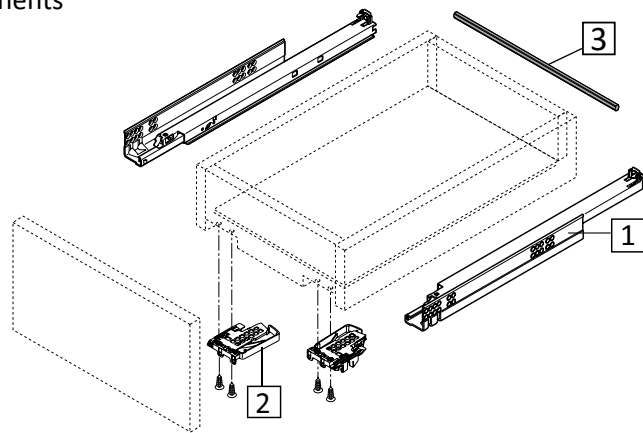

1. Runners
2. Locking Device
3. TIP-ON Synchronisation Cable

### Height Requirement

Z = 21.0 mm TANDEM-16  
 Z = 24.5 mm TANDEM-19  
 A = 3mm to interchange with full extension

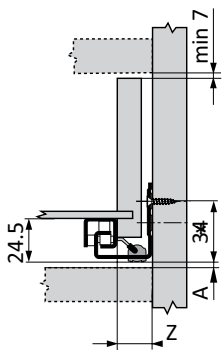

IDW = Internal drawer width

ICW = Inner cabinet width

X = 42 mm TANDEM-16

X = 49 mm TANDEM-19

Y = 16 mm TANDEM-16

Y = 19 mm TANDEM-19

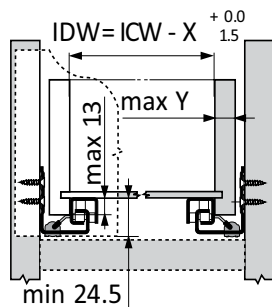

DL = Drawer Length

NL = Nominal Length

Y = Hook Position

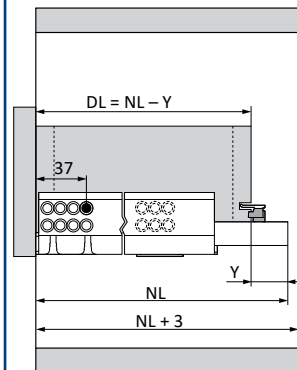

IDL = Inner Drawer Length

DL = Drawer Length

NL = Nominal Length

X = Drawer Front

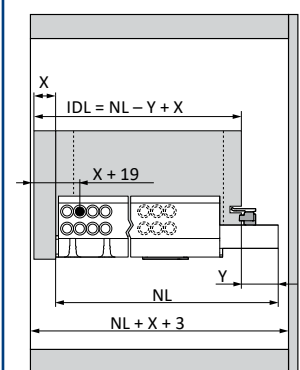

Note: For runner positions and further technical information see Page 1.111 - 1.113

## Blum TANDEM TIP-ON 7/8 Extension - Locking Device

Drawer Assembly - Front

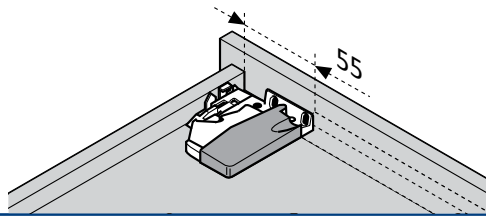

Drawer Assembly - Back

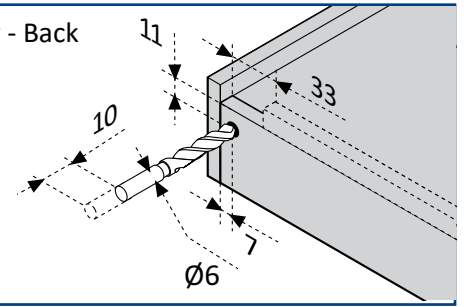

### TANDEM 7/8 Extension

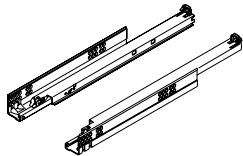

Drawer Depth	Nominal Length	TANDEM-16 25 kg	TANDEM-19 25 kg	P.U
300 mm	325 mm	B540H300T	B540F270T	6
350 mm	375 mm	B540H350T	B540F350T	6
400 mm	435 mm	B540H400T	B540F400T	6
450 mm	485 mm	B540H450T	B540F450T	6
500 mm	530 mm	B540H500T	B540F500T	6

### TANDEM Height Adjustable Locking Device

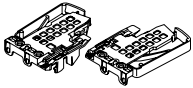

Fixing Method	Left Hand	Right Hand	P.U
Screw On	BT511700L	BT511700R	100

### TANDEM depth stop for Inner Drawers (Recommended)

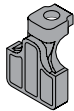

Art. No.	P.U
B2985500	10

### TANDEM Locking Device (Alternative)



Fixing Method	Left Hand	Right Hand	P.U
Screw On	BT511400L	BT511400R	300

No height adjustment and cannot be used with Depth Stop above

### Back fixing bracket for MOVENTO / TANDEM (Optional)

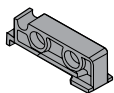

Art. No.	P.U
BT517000.01	10

For pull out shelves or where no hole is drilled in the back of drawer.  
Used Left and right, reduce the drawer side depth by an additional 10 mm

### TIP-ON Synchronisation Cable



Fixing Method	Cabinet Widths	Cable 1142 mm	P.U
Tool Free	Up to 1200 mm	BT571142S	300

Cut to Suit Internal Cabinet Width - 37 mm. Recommended for all widths

See Page 1.110 to establish the trigger range on door fronts for TIP-ON solution

## Blum TANDEM TIP-ON Single Extension - Locking Device



- Drawer panel widths up to 16 mm with TANDEM-16 and up to 19 mm can be used with TANDEM-19
- Concealed TANDEM runner
- Integrated TIP-ON opening system for handleless fronts
- Carriage system with high impact cylindrical rollers
- 30kg dynamic load capacity up to runner length 550 mm
- Tool free height adjustment
- Built in width and depth tolerance compensation

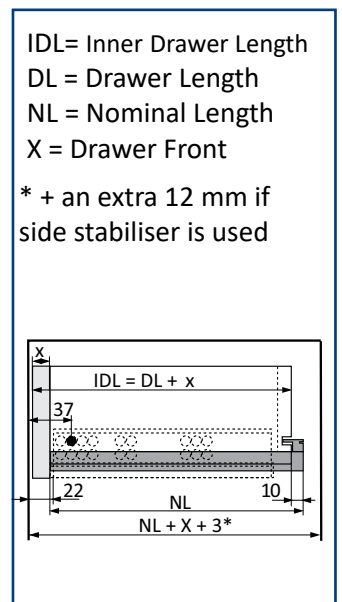
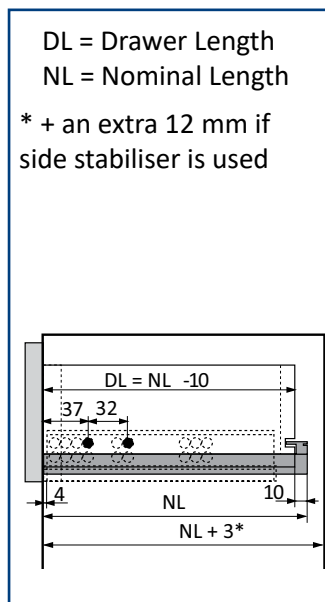
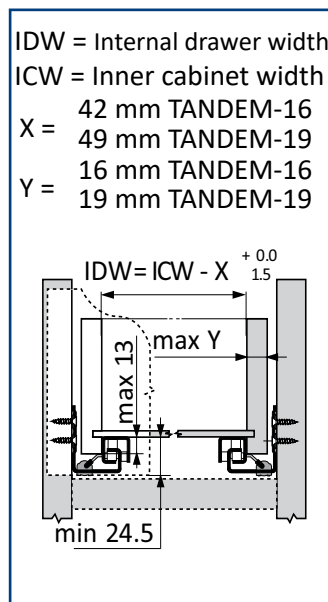
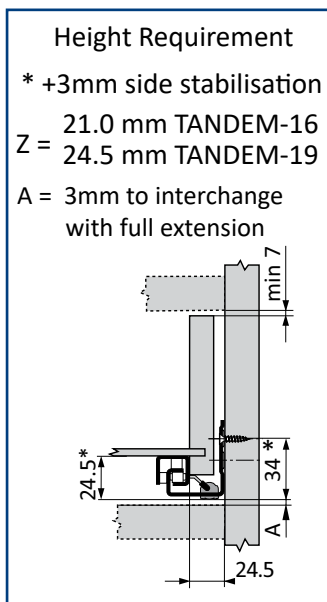
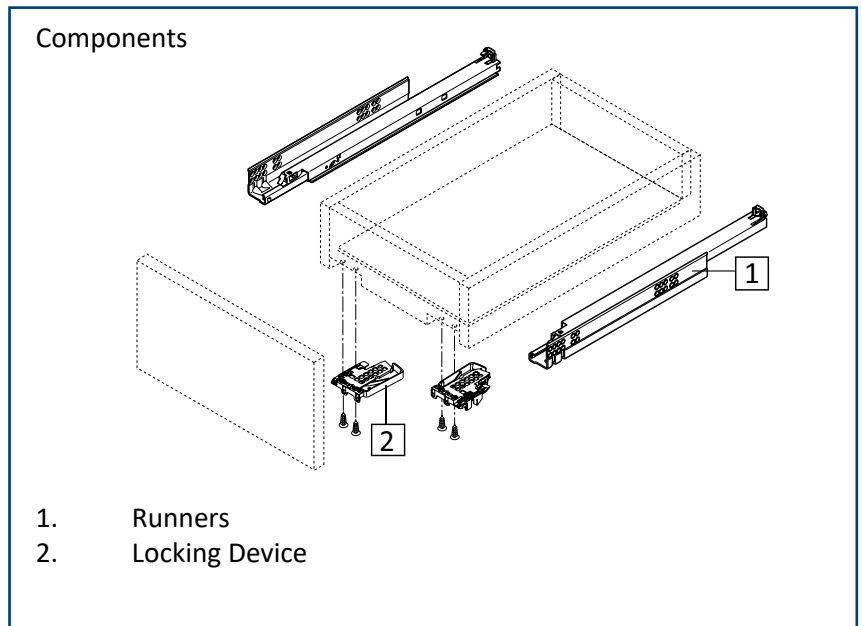
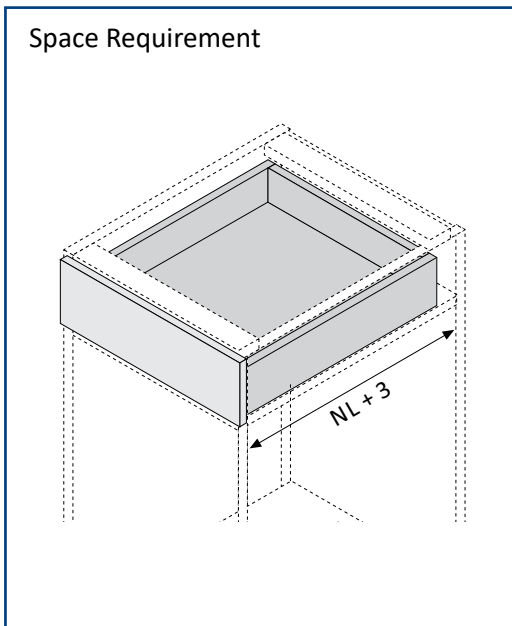

Note: For runner positions and further technical information see Page 1.111 - 1.113

## Blum TANDEM TIP-ON Single Extension - Locking Device

Drawer Assembly - Front

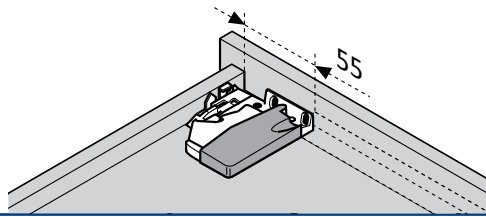

Drawer Assembly - Back

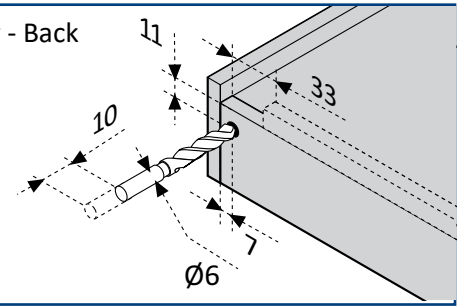

### TANDEM TIP-ON Single Extension

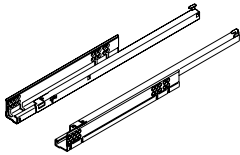

Nominal Length	TANDEM-16 30 kg	TANDEM-19 30 kg	P.U
270 mm	B550H270T	B550F270T	12
300 mm	B550H350T	B550F350T	12
400 mm	B550H400T	B550F400T	12
450 mm	B550H450T	B550F450T	12
500 mm	B550H500T	B550F500T	12
550 mm	B550H550T	B550F550T	12

### TANDEM Locking Device

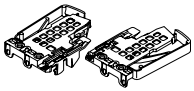

Fixing Method	Left Hand	Right Hand	P.U
Screw On	BT511700L	BT511700R	100

### TANDEM depth stop for Inner Drawers (Recommended)

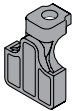

Art. No.	P.U
B2985500	10

### TANDEM Locking Device (Alternative)

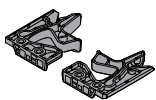

Fixing Method	Left Hand	Right Hand	P.U
Screw On	BT511400L	BT511400R	300

No height adjustment and cannot be used with Depth Stop above

### Back fixing bracket for MOVENTO / TANDEM (Optional)

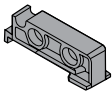

Art. No.	P.U
BT517000.01	10

For pull out shelves or where no hole is drilled in the back of drawer.  
Used Left and right, reduce the drawer side depth by an additional 10 mm

### TIP-ON Synchronisation cable



Fixing Method	Cabinet Widths	Cable 1142 mm	P.U
Tool Free	Up to 1200 mm	BT571142S	300

Cut to Suit Internal Cabinet Width - 37 mm. Recommended for all widths

See Page x-xx to establish the trigger range on door fronts for TIP-ON solution

## Blum TANDEM BLUMOTION Full Extension Peg Fix

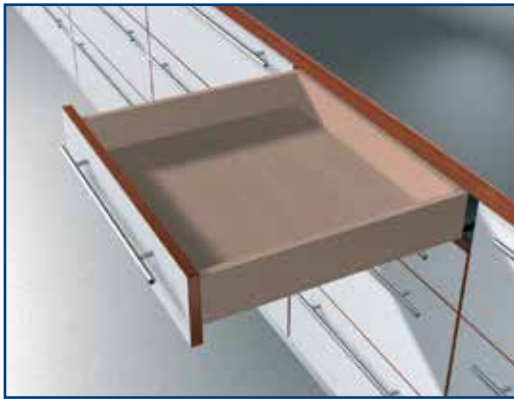

- Drawer panel widths up to 16 mm with TANDEM-16 and up to 19 mm can be used with TANDEM-19
- TANDEM Concealed runner system with peg fix assembly
- Integrated BLUMOTION Soft close option
- Carriage system with high impact cylindrical rollers
- 30kg dynamic load capacity up to runner length 560 mm
- Integrated lift-off stop and height adjustment
- Tool-free integrated front tilt adjustment

### BLUMOTION

inside

#### Space Requirement

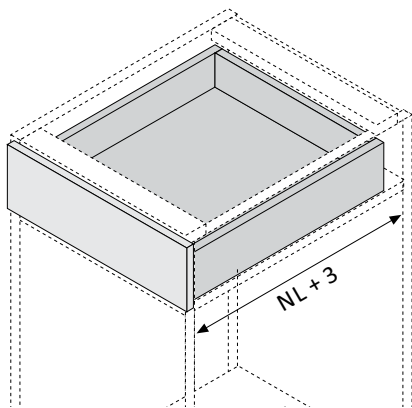

#### Components

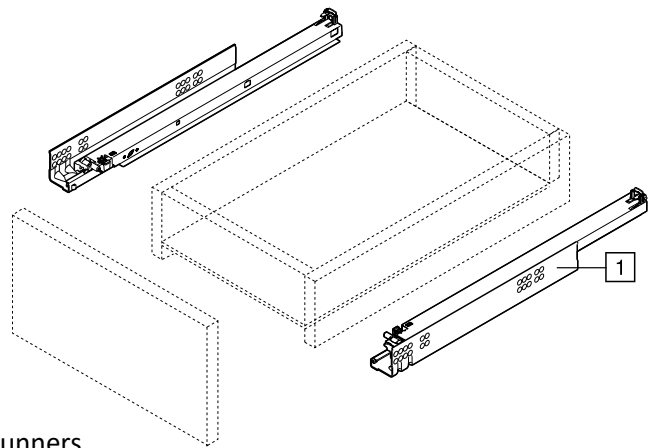

1. Runners

#### Height Requirement

Z = 21.0 mm TANDEM-16  
 Z = 24.5 mm TANDEM-19  
 \* +3mm side stabilisation

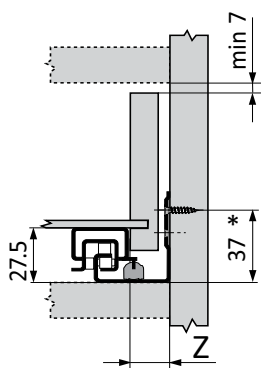

IDW = Internal drawer width  
 ICW = Inner cabinet width  
 X = 42 mm TANDEM-16  
 X = 49 mm TANDEM-19  
 Y = 16 mm TANDEM-16  
 Y = 19 mm TANDEM-19

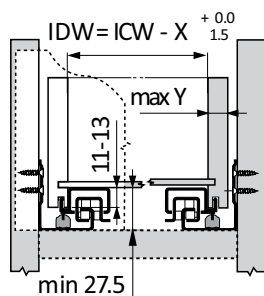

DL = Drawer Length  
 NL = Nominal Length  
 \* + an extra 12 mm if side stabiliser is used

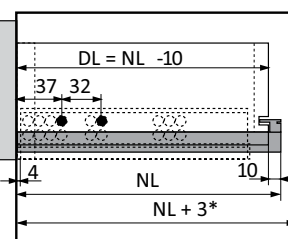

IDL = Inner Drawer Length  
 DL = Drawer Length  
 NL = Nominal Length  
 X = Drawer Front  
 \* + an extra 12 mm if side stabiliser is used

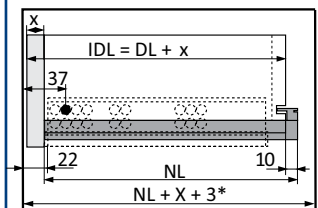

## Blum TANDEM BLUMOTION Full Extension Peg Fix

Drawer Side Drilling

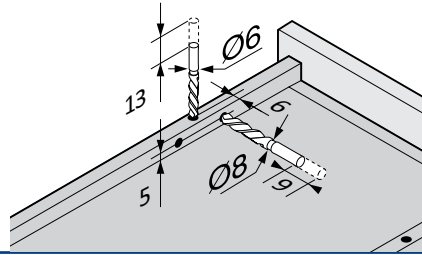

Drawer Assembly - Back

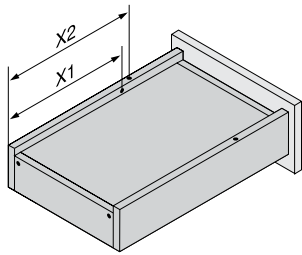
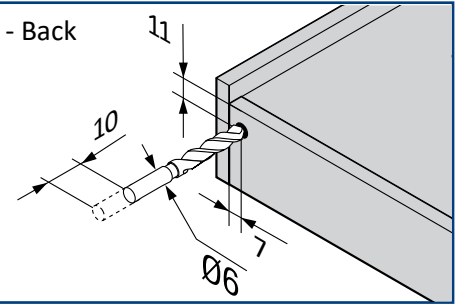

NL mm	X1	X2	NL mm	X1	X2
260	185	205	435	354	310
285	200	220	460	379	335
310	242	230	485	394	350
335	257	245	510	436	360
360	287	275	535	451	375
385	297	285	560	481	405
410	344	300			

### TANDEM BLUMOTION Full Extension Peg Fix

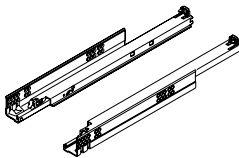

Nominal Length	TANDEM-16 30 kg	TANDEM-19 30 kg	P.U
260 mm	B561H260B	B561F260B	12
285 mm	B561H285B	-	12
310 mm	B561H310B	B561F310B	12
335 mm	B561H335B	-	12
360 mm	B561H360B	B561F360B	12
385 mm	B561H385B	-	12
410 mm	B561H410B	B561F410B	12
435 mm	B561H435B	-	12
460 mm	B561H460B	B561F460B	12
485 mm	B561H485B	-	12
510 mm	B561H510B	B561F510B	12
535 mm	B561H535B	-	12
560 mm	B561H560B	B561F560B	12

### TANDEM Side Stabilisation Kit (Optional)



Drawer Length	Art. No.	P.U
≤ 750 mm	BZST750TV	10

For cabinet widths ≤ 1400mm for Cutting to size

### Back fixing bracket for MOVENTO / TANDEM (Optional)

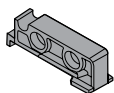

Art. No.	P.U
BT517000.01	10

For pull out shelves or where no hole is drilled in the back of drawer.  
Used Left and right, reduce the drawer side depth by an additional 10 mm

## Blum TANDEM BLUMOTION 7/8 Extension - Peg Fix



- Drawer panel widths up to 16 mm with TANDEM-16 and up to 19 mm can be used with TANDEM-19
- Concealed TANDEM 7/8 extension
- Integrated BLUMOTION for silent and effortless closing
- Carriage system with high impact cylindrical rollers
- 25kg dynamic load capacity up to runner length 500 mm
- Tool free height adjustment
- Built in width and depth tolerance compensation

### BLUMOTION

inside

#### Space Requirement

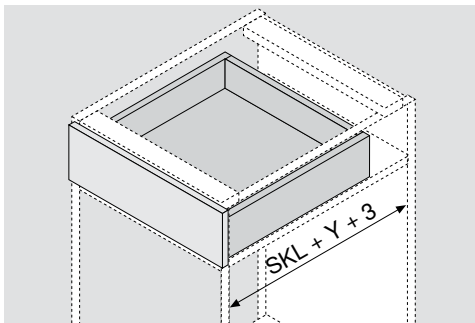

Drawer Depth (SKL) mm	Y
300 mm / 350 mm	25 mm
400 mm / 450 mm	35 mm
500 mm	30 mm

#### Components

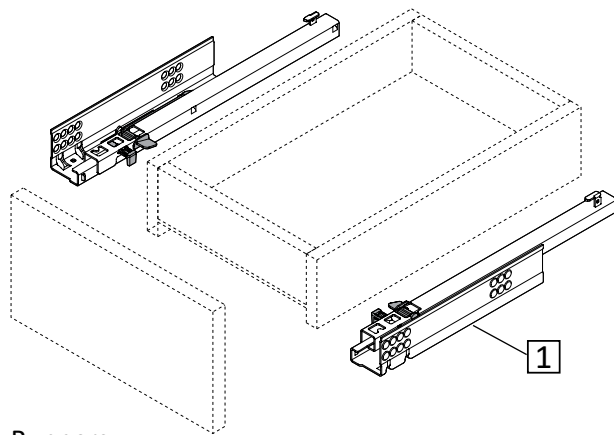

1. Runners

#### Height Requirement

Z = 21.0 mm TANDEM-16  
 Z = 24.5 mm TANDEM-19  
 A = 3mm to interchange with full extension

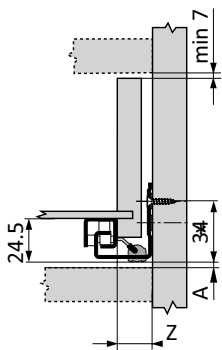

IDW = Internal drawer width

ICW = Inner cabinet width

X = 42 mm TANDEM-16

X = 49 mm TANDEM-19

Y = 16 mm TANDEM-16

Y = 19 mm TANDEM-19

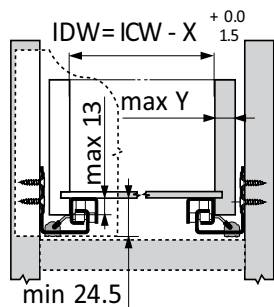

DL = Drawer Length

NL = Nominal Length

Y = Hook Position

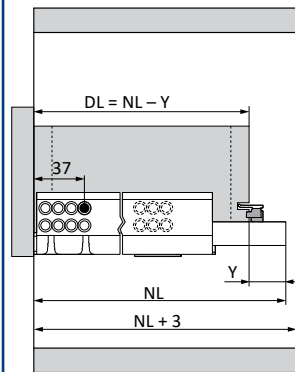

IDL = Inner Drawer Length

DL = Drawer Length

NL = Nominal Length

X = Drawer Front

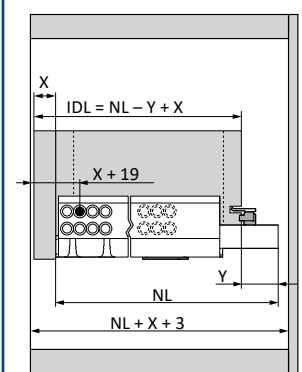

Note: For runner positions and further technical information see Page 1.111 - 1.113



## Blum TANDEM BLUMOTION 7/8 Extension Peg Fix

Drawer Side Drilling

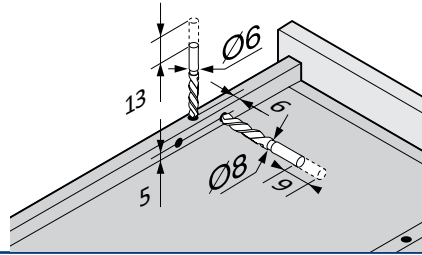

Drawer Assembly - Back

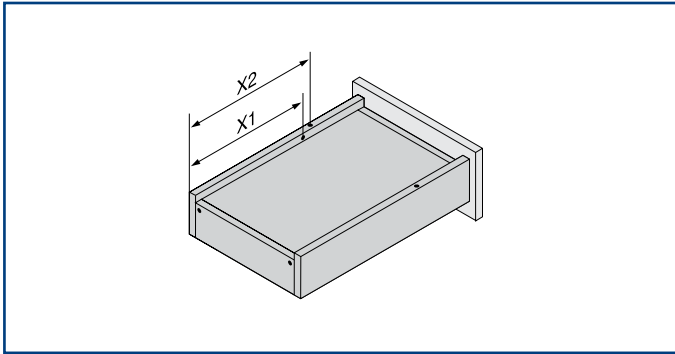
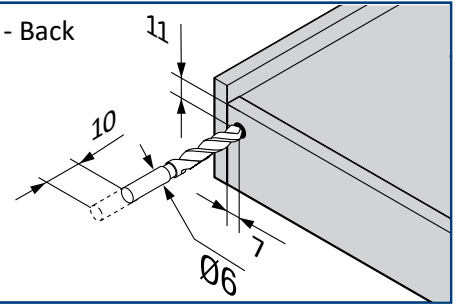

NL mm	X1 Lift-Off Stop	X2 Pegs
300	250	230
350	255	275
400	280	300
450	315	335
500	380	360

### TANDEM 7/8 Extension

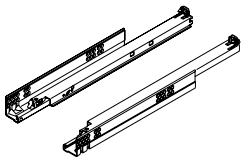

Drawer Depth	Nominal Length	TANDEM-16 25 kg	TANDEM-19 25 kg	P.U
300 mm	325 mm	B541H300B	B541F270B	6
350 mm	375 mm	B541H350B	B541F350B	6
400 mm	435 mm	B541H400B	B541F400B	6
450 mm	485 mm	B541H450B	B541F450B	6
500 mm	530 mm	B541H500B	B541F500B	6

## Blum TANDEM BLUMOTION Single Extension Peg Fix



- Drawer panel widths up to 16 mm with TANDEM-16 and up to 19 mm can be used with TANDEM-19
- Concealed TANDEM runner system with peg fix assembly
- Integrated BLUMOTION for silent and effortless closing
- Carriage system with high impact cylindrical rollers
- 30kg dynamic load capacity up to runner length 550 mm
- Tool free height adjustment
- Built in width and depth tolerance compensation

### BLUMOTION

inside

#### Space Requirement

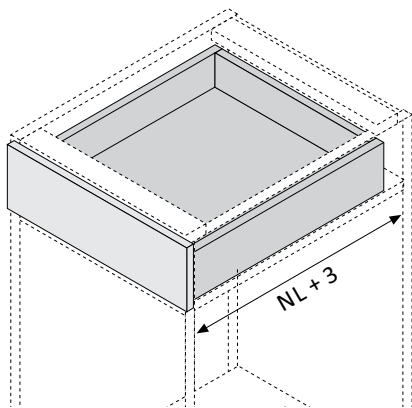

#### Components

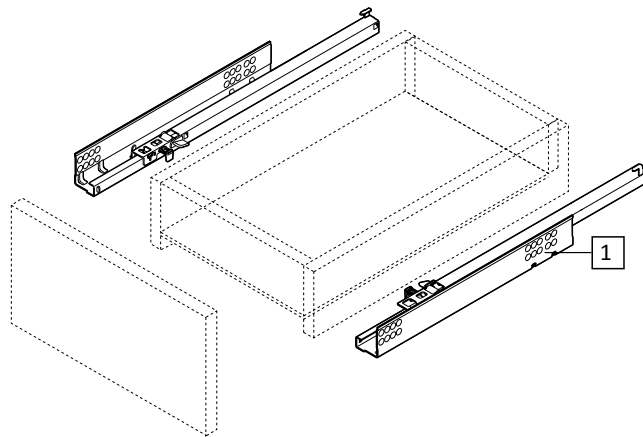

1. Runners

#### Height Requirement

Z = 21.0 mm TANDEM-16  
 Z = 24.5 mm TANDEM-19  
 \* +3mm side stabilisation  
 A 3mm to interchange with full extension

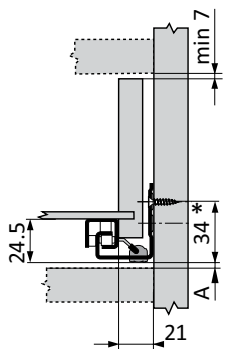

IDW = Internal drawer width  
 ICW = Inner cabinet width  
 X = 42 mm TANDEM-16  
 X = 49 mm TANDEM-19  
 Y = 16 mm TANDEM-16  
 Y = 19 mm TANDEM-19

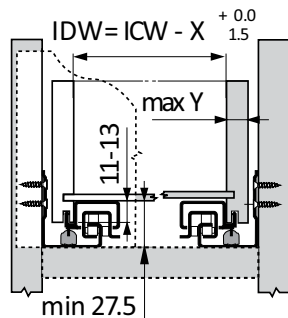

DL = Drawer Length  
 NL = Nominal Length  
 \* + an extra 12 mm if side stabiliser is used

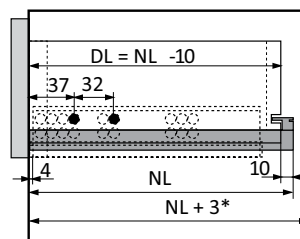

IDL = Inner Drawer Length  
 DL = Drawer Length  
 NL = Nominal Length  
 X = Drawer Front  
 \* + an extra 12 mm if side stabiliser is used

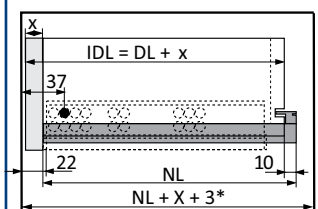

## Blum TANDEM BLUMOTION Single Extension Peg Fix

Drawer Side Drilling

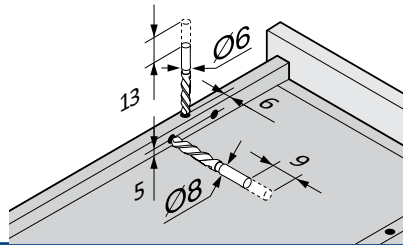

Drawer Assembly - Back

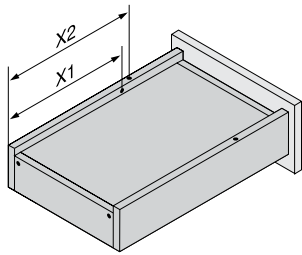
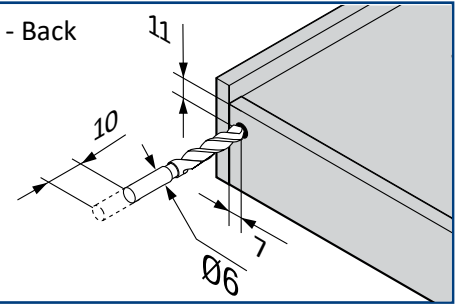

NL mm	X1	X2	NL mm	X1	X2
260	185	205	435	354	310
285	200	220	460	379	335
310	242	230	485	394	350
335	257	245	510	436	360
360	287	275	535	451	375
385	297	285	560	481	405
410	344	300			

### TANDEM BLUMOTION Single Extension Peg Fix

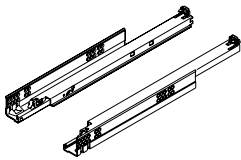

Nominal Length	TANDEM-16 30 kg	TANDEM-19 30 kg	P.U
260 mm	B551H260B	B551F260B	12
285 mm	B551H285B	-	12
310 mm	B551H310B	B551F310B	12
335 mm	B551H335B	-	12
360 mm	B551H360B	B551F360B	12
385 mm	B551H385B	-	12
410 mm	B551H410B	B551F410B	12
435 mm	B551H435B	-	12
460 mm	B551H460B	B551F460B	12
485 mm	B551H485B	-	12
510 mm	B551H510B	B551F510B	12
535 mm	B551H535B	-	12
560 mm	B551H560B	B551F560B	12

### TANDEM Side Stabilisation Kit (Optional)



Drawer Length	Art. No.	P.U
≤ 750 mm	BZST750TV	10

For cabinet widths ≤ 1400mm for Cutting to size

### Back fixing bracket for MOVENTO / TANDEM (Optional)

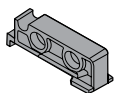

Art. No.	P.U
BT517000.01	10

For pull out shelves or where no hole is drilled in the back of drawer.  
Used Left and right, reduce the drawer side depth by an additional 10 mm

## Blum TANDEM TIP-ON 7/8 Extension - Peg Fix



- Drawer panel widths up to 16 mm with TANDEM-16 and up to 19 mm can be used with TANDEM-19
- Concealed TANDEM 7/8 extension
- Integrated TIP-ON opening system for handleless fronts
- Carriage system with high impact cylindrical rollers
- 25kg dynamic load capacity up to runner length 500 mm
- Tool free height adjustment
- Built in width and depth tolerance compensation

**TIP-ON**

inside

### Space Requirement

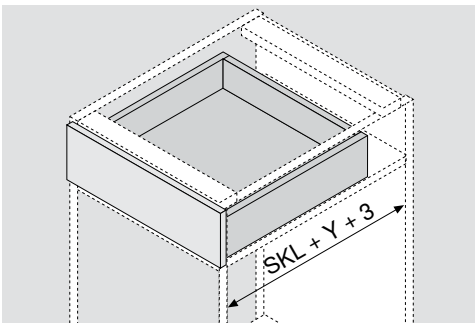

Drawer Depth (SKL) mm	Y
300 mm / 350 mm	25 mm
400 mm / 450 mm	35 mm
500 mm	30 mm

### Components

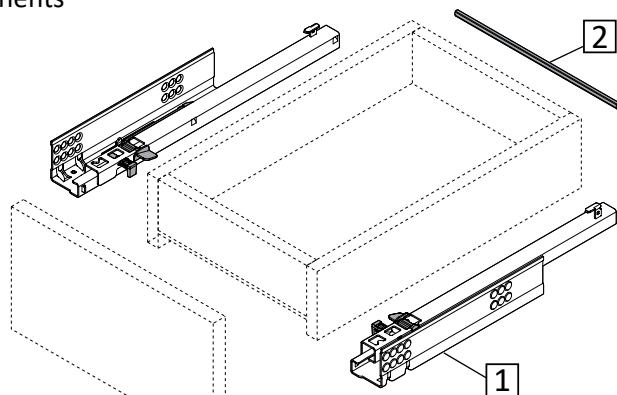

1. Runners
2. TIP-ON Synchronisation Cable

### Height Requirement

Z = 21.0 mm TANDEM-16  
 Z = 24.5 mm TANDEM-19  
 A = 3mm to interchange with full extension

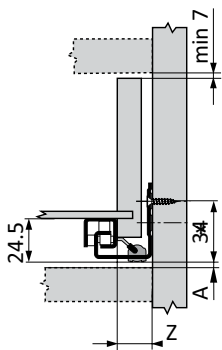

IDW = Internal drawer width

ICW = Inner cabinet width

X = 42 mm TANDEM-16

X = 49 mm TANDEM-19

Y = 16 mm TANDEM-16

Y = 19 mm TANDEM-19

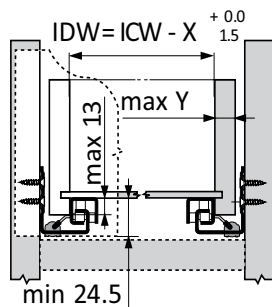

DL = Drawer Length

NL = Nominal Length

Y = Hook Position

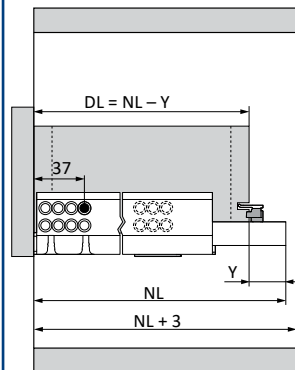

IDL = Inner Drawer Length

DL = Drawer Length

NL = Nominal Length

X = Drawer Front

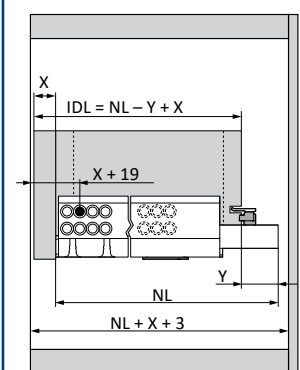

## Blum TANDEM TIP-ON 7/8 Extension Peg Fix

Drawer Side Drilling

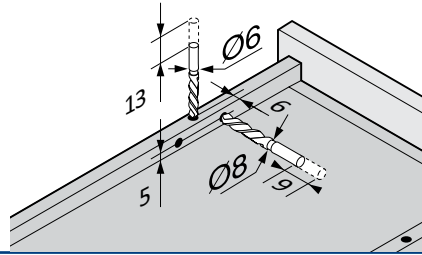

Drawer Assembly - Back

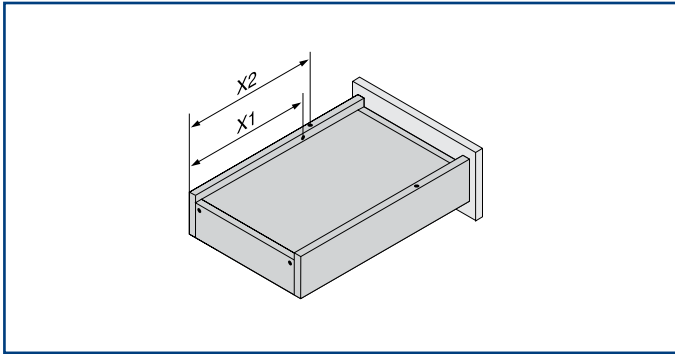
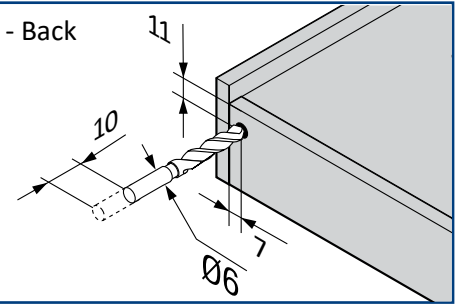

NL mm	X1 Lift-Off Stop	X2 Pegs
300	250	230
350	255	275
400	280	300
450	315	335
500	380	360

### TANDEM TIP-ON 7/8 Extension

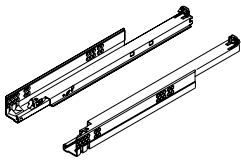

Drawer Depth	Nominal Length	TANDEM-16 25 kg	TANDEM-19 25 kg	P.U
300 mm	325 mm	B541H300T	B541F270T	6
350 mm	375 mm	B541H350T	B541F350T	6
400 mm	435 mm	B541H400T	B541F400T	6
450 mm	485 mm	B541H450T	B541F450T	6
500 mm	530 mm	B541H500T	B541F500T	6

### TIP-ON Synchronisation cable



Fixing Method	Cabinet Widths	Cable 1142 mm	P.U
Tool Free	Up to 1200 mm	BT571142S	300

Cut to Suit Internal Cabinet Width - 37 mm. Recommended for all widths

## Blum TANDEM TIP-ON Single Extension - Peg Fix



- Drawer panel widths up to 16 mm with TANDEM-16 and up to 19 mm can be used with TANDEM-19
- Concealed TANDEM runner
- Integrated TIP-ON opening system for handleless fronts
- Carriage system with high impact cylindrical rollers
- 30kg dynamic load capacity up to runner length 550 mm
- Tool free height adjustment
- Built in width and depth tolerance compensation

**TIP-ON**

inside

### Space Requirement

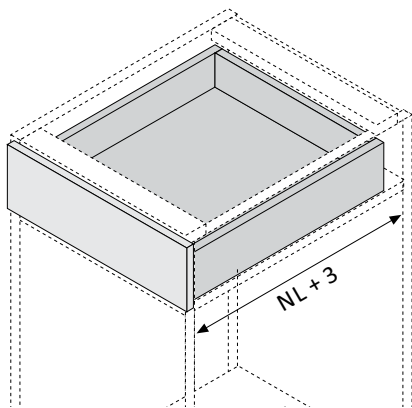

### Components

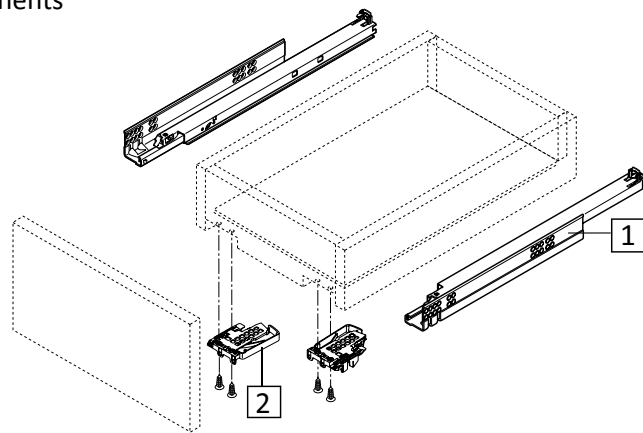

1. Runners
2. Locking Device

### Height Requirement

\* +3mm side stabilisation

Z = 21.0 mm TANDEM-16

Z = 24.5 mm TANDEM-19

A = 3mm to interchange with full extension

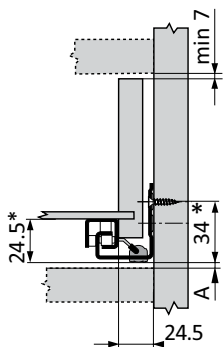

IDW = Internal drawer width

ICW = Inner cabinet width

X = 42 mm TANDEM-16

X = 49 mm TANDEM-19

Y = 16 mm TANDEM-16

Y = 19 mm TANDEM-19

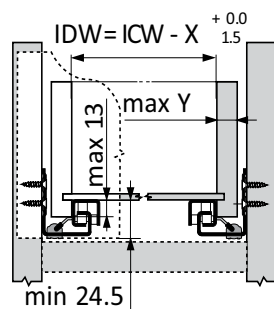

DL = Drawer Length

NL = Nominal Length

\* + an extra 12 mm if side stabiliser is used

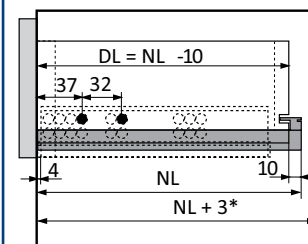

IDL = Inner Drawer Length

DL = Drawer Length

NL = Nominal Length

X = Drawer Front

\* + an extra 12 mm if side stabiliser is used

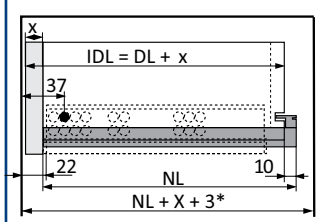

Note: For runner positions and further technical information see Page 1.111 - 1.113

## Blum TANDEM TIP-ON Single Extension Peg Fix

Drawer Assembly - Front

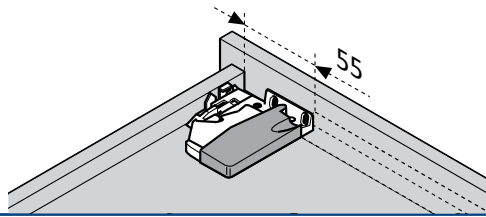

Drawer Assembly - Back

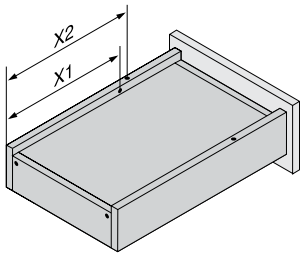
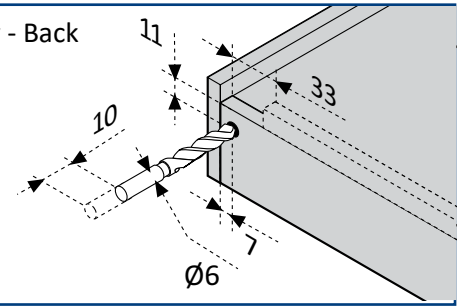

NL mm	X1	X2	NL mm	X1	X2
260	185	205	435	354	310
285	200	220	460	379	335
310	242	230	485	394	350
335	257	245	510	436	360
360	287	275	535	451	375
385	297	285	560	481	405
410	344	300			

### TANDEM TIP-ON Single Extension Peg Fix

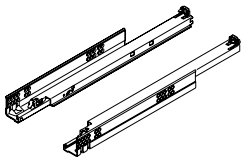

Nominal Length	TANDEM-16 30 kg	TANDEM-19 30 kg	P.U
260 mm	B551H260T	B551F260T	12
285 mm	B551H285T	-	12
310 mm	B551H310T	B551F310T	12
335 mm	B551H335T	-	12
360 mm	B551H360T	B551F360T	12
385 mm	B551H385T	-	12
410 mm	B551H410T	B551F410T	12
435 mm	B551H435T	-	12
460 mm	B551H460T	B551F460T	12
485 mm	B551H485T	-	12
510 mm	B551H510T	B551F510T	12
535 mm	B551H535T	-	12
560 mm	B551H560T	B551F560T	12

### TANDEM Side Stabilisation Kit (Optional)



Drawer Length	Art. No.	P.U
≤ 750 mm	BZST750TV	10

For cabinet widths ≤ 1400mm for Cutting to size

### TIP-ON Synchronisation cable



Fixing Method	Cabinet Widths	Cable 1142 mm	P.U
Tool Free	Up to 1200 mm	BT571142S	300

Cut to Suit Internal Cabinet Width - 37 mm. Recommended for all widths

## TIP-ON for TANDEM



- TANDEM runner system with TIP-ON opening
- Only works with NON BLUMOTION Tandem runners
- Available on all Single and Full Extension runners in TANDEM range
- Minimum Order Quantities and lead times apply
- Please contact our sales team for detailed manufacturing specifications

### TIP-ON Trigger Range

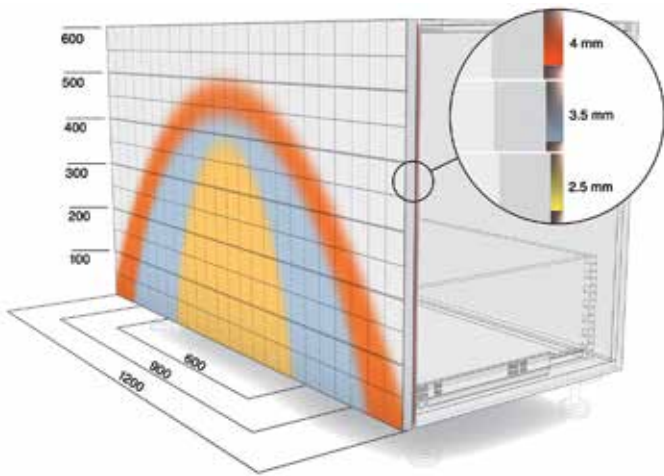

### Components

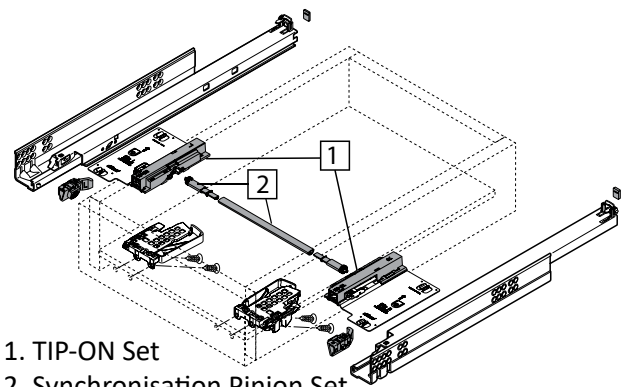

1. TIP-ON Set
2. Synchronisation Pinion Set
3. Synchronisation linkage

### TANDEM TIP-ON Set

	Runner	Locking	Extension	KG		P.U
	TANDEM 19	Locking Device	Full	30kg	BT557150S	12
	TANDEM	Peg Fix				
	TANDEM 19	Locking Device	Full	50kg	BT559150S	12
	TANDEM	Peg Fix				
	TANDEM 19	Locking Device	Single	30kg	BT551150S	12
	TANDEM	Peg Fix				

### Synchronisation Rods for TIP-ON for TANDEM

	Link Rod Length	Link Rod Code	P.U	Bracket Set (2 pcs)	P.U
	899 mm	BT55899W	40	BT55000R	40

*Note: Cut to suit all drawer widths: Internal Carcase Width - 277 mm*



### TANDEM Cabinet profile fixing positions

TANDEM with Locking Device		TANDEM with Peg Fix	
Full Extension	Single Extension	Full Extension	Single Extension
270	270	260	260 - 285
-	350 - 450	285	310 - 435
350		310 - 335	460 - 485
400		410	
450		435 - 460 - 485	
500 - 550	500 - 500	510 - 535	510 - 535
600	600	560	560
650 - 750	650		

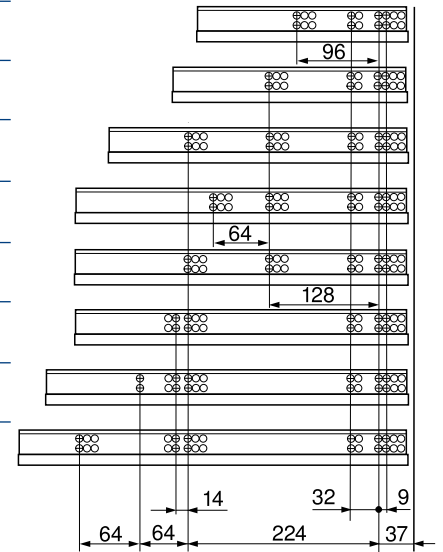

### Locking Device - Assembly

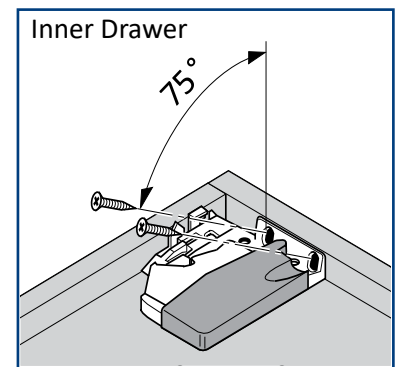
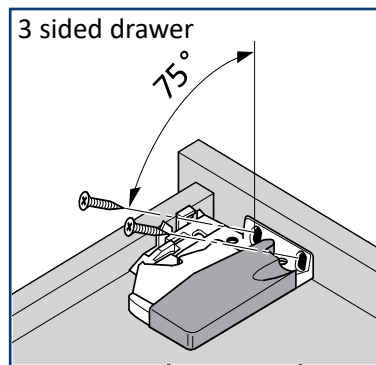
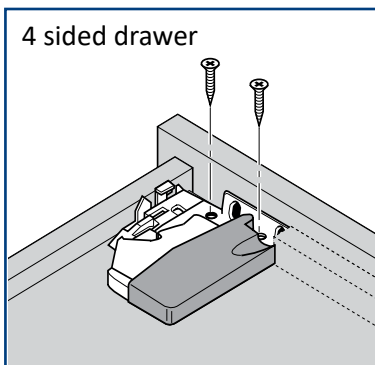

### Removal and Adjustments

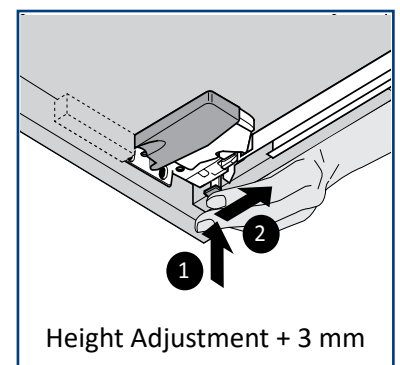
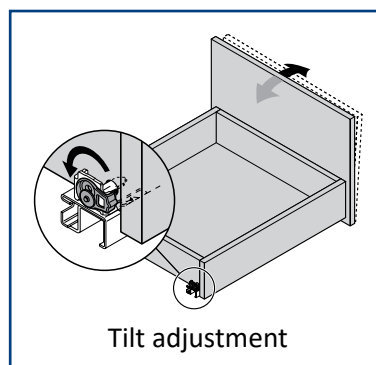
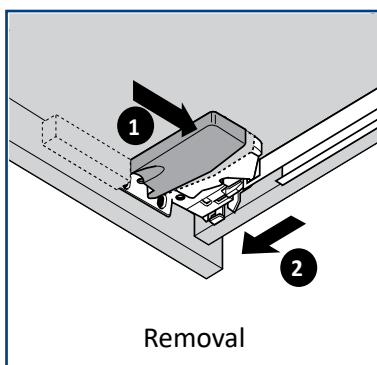

### Space Requirements in Cabinet

- 1 TANDEM Full Extension with locking device  
TANDEM Full Extension peg fix
- 2 TANDEM Single Extension with locking device  
TANDEM Single Extension peg fix

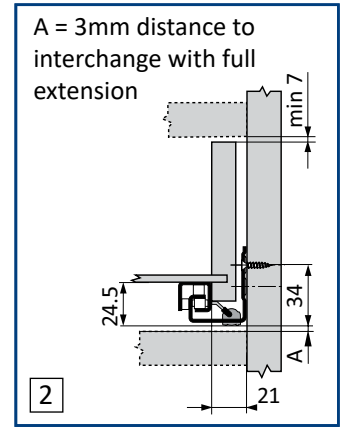
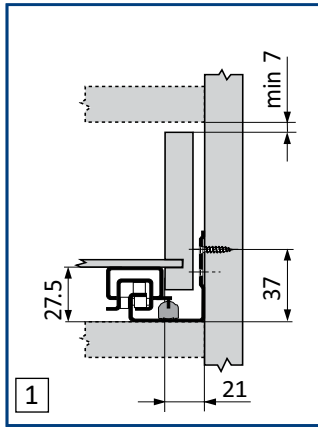

### Drawer Length

- 1 Standard Timber Drawer
- 2 Inner Timber Drawer

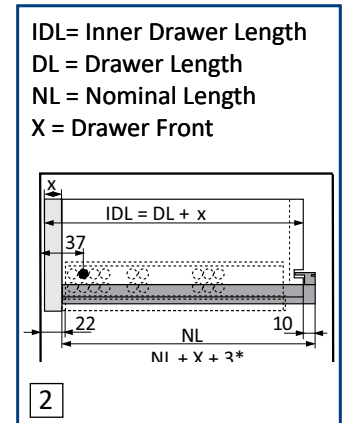
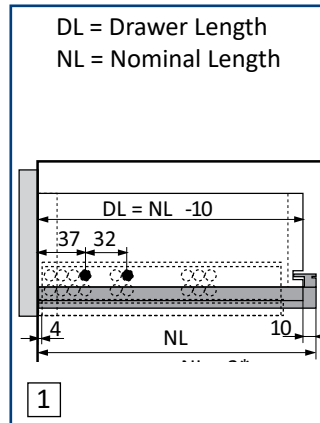

### Drawer Dimensions - Full Extension

- 1 TANDEM Full Extension with locking device
- 2 TANDEM Full Extension peg fix

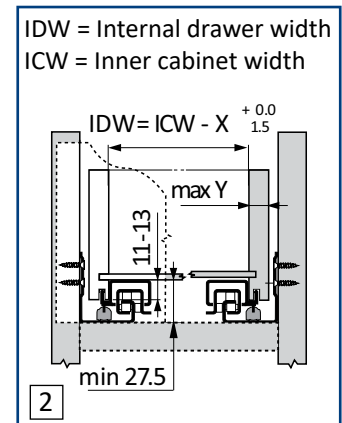
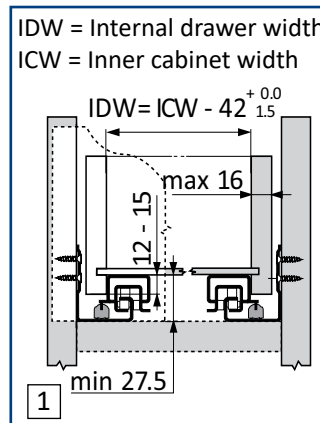

### Drawer Dimensions - Single Extension

- 1 TANDEM Single Extension with locking device
- 2 TANDEM Single Full Extension peg fix

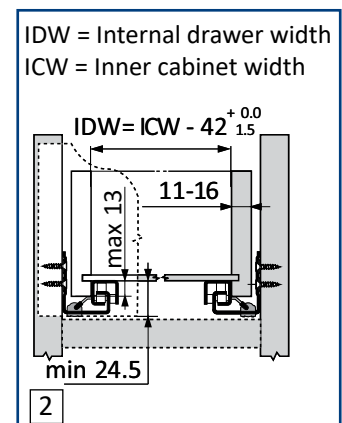
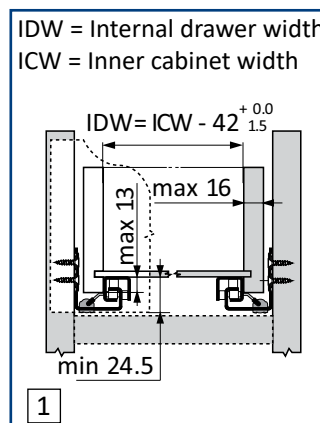

### TANDEM Peg Fix - Drawer Drilling Positions

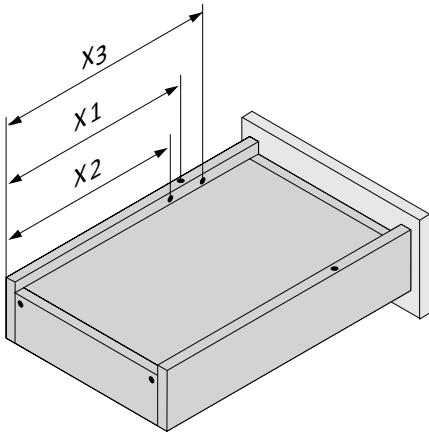

Nominal Length	X1 - Pegs	X2 Lift Off Stop Single Extension	X3 Lift Off Stop Full Extension
260 mm	205	185	185
285 mm	220	200	200
310 mm	230	210	242
335 mm	245	225	257
360 mm	275	255	287
385 mm	285	265	297
410 mm	300	280	344
435 mm	310	290	354
460 mm	335	315	379
485 mm	350	330	394
510 mm	360	340	436
535 mm	375	355	451
560 mm	405	385	481

### Locking Device - Assembly

1 TANDEM Full Extension Peg Fix

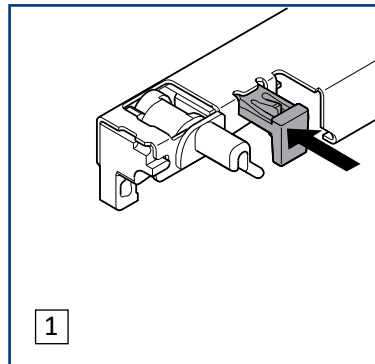

2 TANDEM Single Extension Peg Fix

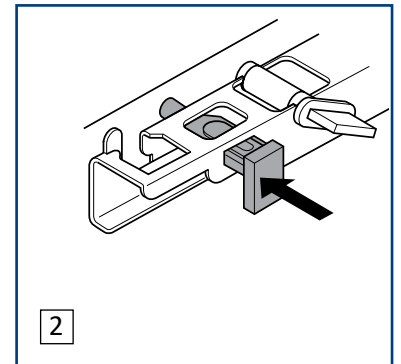

### Locking Device - Removal

1 TANDEM Full Extension Peg Fix

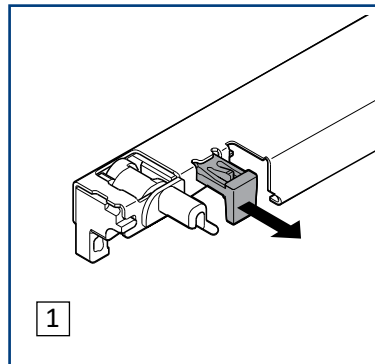

2 TANDEM Single Extension Peg Fix

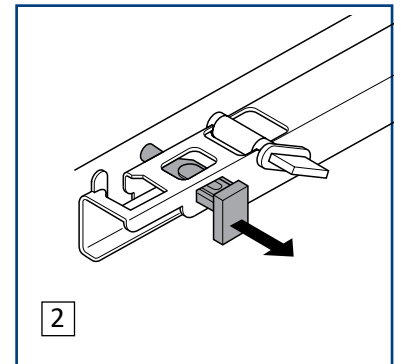

### Height Adjustment +2.5 mm

1 TANDEM Full Extension Peg Fix

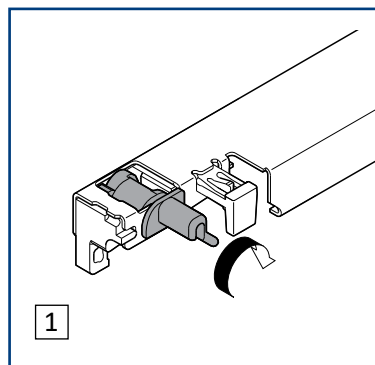

2 TANDEM Single Extension Peg Fix

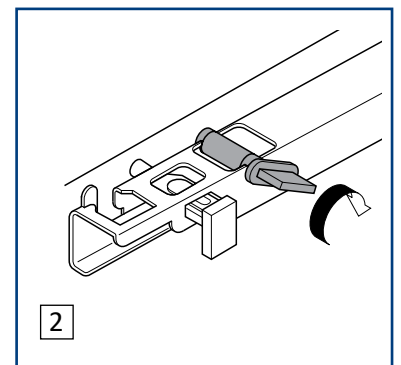

## Standard Runners

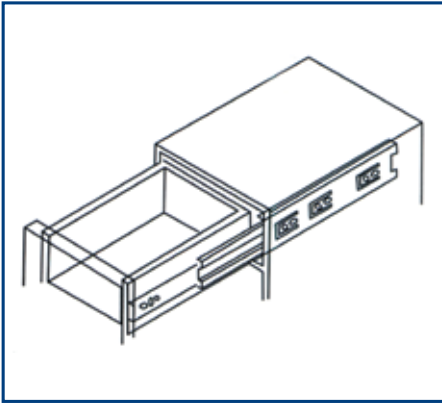

### Ballbearing Runners

- Full extension system
- Easy removal and insertion
- Narrow profile 12.7mm
- 45kg weight capacity
- 32mm system drill holes
- Full Programme



### BALLBEARING RUNNERS

Art. No.	Length	Finish	Min Internal Depth	P.U
FR5000250	250 mm	Zinc	254mm	10
FR5000300	300 mm	Zinc	304mm	10
FR5000350	350 mm	Zinc	354mm	10
FR5000400	400 mm	Zinc	404mm	10
FR5000450	450 mm	Zinc	454mm	10
FR5000500	500 mm	Zinc	504mm	10
FR5000550	550 mm	Zinc	554mm	10
FR5000600	600 mm	Zinc	604mm	10
FR5000700	700 mm	Zinc	704mm	10