

AVENTOS HF Bi-FOLD

AVENTOS HF Bi-Fold Lift

- Soft closing and soft opening action
- Variable stop position
- Fast easy assembly using clip technology
- Adapted centre hinge for safety
- 3 way door adjustment and telescopic arm adjustment
- Simple and fast tension adjustment for optimum action
- Minimum cabinet depth 278mm
- No protruding parts for safe and easy transport
- Narrow telescopic arm for maximum storage within the cabinet
- New SERVO Drive for AVENTOS, the electrical motion support for wall cabinets



Lift and Slide

Drilling Position

* Drill depth 5 mm
** Alternative drilling

Cabinet height (CH)	H (mm)
480 - 549 mm	CH x 0.3 - 28 mm
550 - 1040 mm	CH x 0.3 - 57 mm

Space Requirement

CH Cabinet Height

Opening Angle Stop

(see page 3.26)

Angle Stop	Y
Without	FH x 0.44 + 38 mm
104°	FH x 0.24 + 34 mm
83°	0 mm

Front Fixing Position

Cabinet height (CH)	X (mm)
480 - 549 mm	68 mm
550 - 1040 mm	45 mm

Drill Position 120° Top hinge

Front Overlay	14	15	16	17
Drilling Distance	3	4	5	6

Based on 0 mm plate supplied

Centre Hinge

Gap	3	4	5	6
DD	6	5	4	3

Door Bumper Position SERVO-DRIVE

NOTE: To obtain the perfect motion AVENTOS HF works on Power Factor (PF). PF = Cabinet height x door weight including handle weight in kg. The tables opposite assume the optimum PF based on 20 mm MDF Door

AVENTOS HF Bi-fold Sets

1. Mechanism 2 pieces
2. Cover Caps L+R
3. Lever Arms 2 pieces
4. HF Hinge Kit

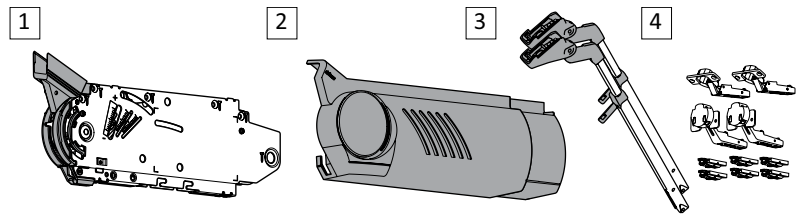

Blum AVENTOS HF Bi-Fold Lift Set

Door Height	Cabinet Width (mm)					
	500 mm	600 mm	800 mm	900 mm	1000 mm	1200 mm
2 pieces 283 mm	B20F2850 2600-5500 PF*	B20F2860 2600-5500 PF*	B20F2880 2600-5500 PF*	B20F2890 2600-5500 PF*	B20F2810 2600-5500 PF*	B20F2812 5350-10150 PF*
2 pieces 355 mm	B20F3550 2600-5500 PF*	B20F3560 2600-5500 PF*	B20F3580 5350-10150 PF*	B20F3590 5350-10150 PF*	B20F3510 5350-10150 PF*	B20F3512 5350-10150 PF*
2 pieces 450 mm	B20F4550 🗣️ 5350-10150 PF*	B20F4560 🗣️ 5350-10150 PF*	B20F4580 🗣️ 9000-17250 PF*	B20F4590 🗣️ 9000-17250 PF*	B20F4510 🗣️ 9000-17250 PF*	B20F4512 🗣️ 9000-17250 PF*

Based on 20 mm MDF Door. PF* = Power Factor. Power factor guide see page 3.26

Note: 3 hinges for cabinets ≥ 1200 mm / 4 hinges for cabinets ≥ 1800 mm

Lift and Slide

AVENTOS HF SERVO-DRIVE Bi-fold Sets

1. Mechanism 2 pieces
2. Cover Caps L+R
3. Lever Arms 2 pieces
4. HF Hinge Kit
5. SERVO-DRIVE Kit

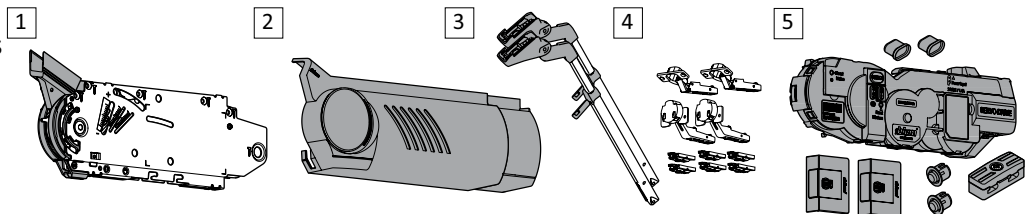

Note: AVENTOS SERVO-DRIVE requires a transformer BZ10NE050SET see page 1.123
One transformer required per kitchen (Island units may require additional transformer).

Blum AVENTOS HF SERVO-DRIVE Bi-Fold Lift Set

Door Height	Cabinet Width mm					
	500 mm	600 mm	800 mm	900 mm	1000 mm	1200 mm
2 pieces 283 mm	B21F2850 2600-5500 PF*	B21F2860 2600-5500 PF*	B21F2880 2600-5500 PF*	B21F2890 2600-5500 PF*	B21F2810 2600-5500 PF*	B21F2812 5350-10150 PF*
2 pieces 355 mm	B21F3550 2600-5500 PF*	B21F3560 2600-5500 PF*	B21F3580 5350-10150 PF*	B21F3590 5350-10150 PF*	B21F3510 5350-10150 PF*	B21F3512 5350-10150 PF*
2 pieces 450 mm	B21F4540 🗣️ 5350-10150 PF*	B21F4560 🗣️ 5350-10150 PF*	B21F4580 🗣️ 9000-17250 PF*	B21F4590 🗣️ 9000-17250 PF*	B21F4510 🗣️ 9000-17250 PF*	B21F4512 🗣️ 9000-17250 PF*

Based on 20 mm MDF Door. PF* = Power Factor. Power factor guide see page 3.26

Note: 3 hinges for cabinets ≥ 1200 mm / 4 hinges for cabinets ≥ 1800 mm